



HYMAX GRIP[®] CUT-IN SLEEVE (4"-8")

HYMAX[®]
Repair the past. Connect the future.

INSTALLATION INSTRUCTIONS

DO NOT DISASSEMBLE THE COUPLING. DO NOT LUBRICATE THE BOLTS.

GENERAL INSTRUCTIONS:

THE HYMAX GRIP CUT-IN SLEEVE IS A STAB-ON TYPE RESTRAINT COUPLING WITH AN MJ CONNECTION ON ONE SIDE, THAT IS APPROVED FOR USE WITH METAL AND PLASTIC PIPES WHEN INSTALLING A NEW ELEMENT IN THE EXISTING LINE.

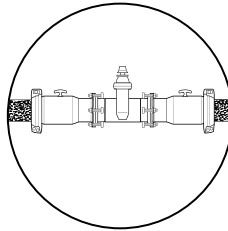
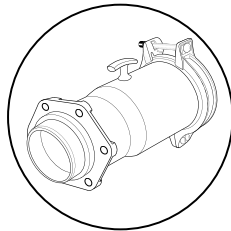
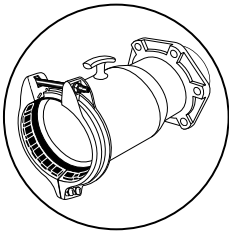

WARNING: DO NOT ATTEMPT TO USE THE PRODUCT ON AC OR FRP PIPE!

PRECAUTIONS FOR HDPE PIPE: THE USE OF FULL CIRCLE STIFFENERS IS REQUIRED WHEN USING THE HYMAX GRIP CUT-IN SLEEVE ON HDPE PIPE.

FOR OTHER MATERIALS, PLEASE CONTACT KRAUSZ USA OR YOUR KRAUSZ DEALER.

NOTE: BOLT IS PRE-LUBRICATED WITH A MAG COATING. THIS EMBEDDED ZINC LUBRICATION WILL PREVENT COLD WELD. DO NOT LUBRICATE THE BOLTS AND NUTS. GREASING OR LUBRICATING BOLTS OR NUTS VOIDS THE MANUFACTURER'S WARRANTY.

STEP 1

Measure the pipe's Outer Diameter and make sure the coupling's size fits properly.

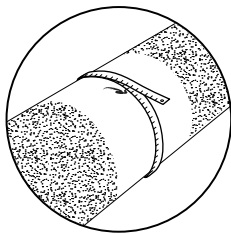

NOTE: Each coupling's size range is shown on the product's label. Make sure that the pipe is not out of round! The HYMAX GRIP CUT-IN SLEEVE may not fit well or function properly on a pipe which is damaged or is out of round.

STEP 2

Cut the pipe - The width of the cut in the pipe should be determined according to the width of the new element as well as the G-min/G-max of the Hymax Grip Cut-in Sleeve product/s as indicated on the product label.

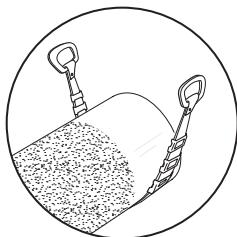

Prepare pipe end by de-scaling if required. Clean the pipe as required with water. Ensure that both the pipe and the face of the MJ fitting or valve are clean from debris and defects that may interfere with the product's proper seal.

NOTE: All pipes must be lubricated with a water-based gasket lubricant in order to achieve a proper seal.

STEP 3

Unpack the product carefully. Inspect the product and end ring for shipping damage. Inspect the end ring. If it is not centered on the HYMAX GRIP CUT-IN SLEEVE - DO NOT USE! Contact your distributor for return and replacement.

Do not loosen or remove the end ring bolt.

STEP 4

Mark pipe end to a required minimum pipe insertion depth as indicated on the product label. These marks indicate the minimum pipe insertion of the pipe (G-min) for the HYMAX GRIP CUT-IN SLEEVE.

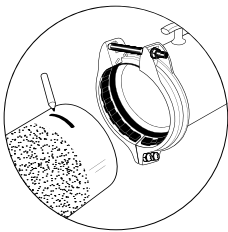

STEP 5

(1) Insert the MJ gasket (not supplied with the product) unto the HYMAX GRIP CUT-IN SLEEVE. (2) Slide the product unto the pipe. (3) Insert the new element and slide the product back in the direction of the new element. (4) Tighten the bolts to the new element. Make sure that you don't slide the product beyond the marked G-min.

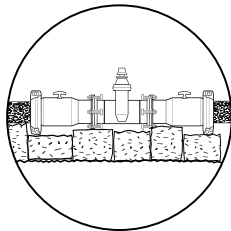
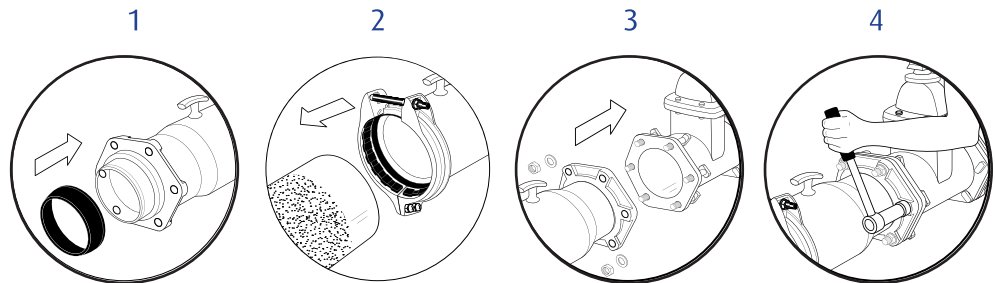

NOTE: Make sure that the pipe is properly supported. The HYMAX GRIP CUT-IN SLEEVE cannot support the weight of the pipe and the new element by itself.

STEP 6

Tighten the end ring using a torque wrench, to the correct torque shown on the product's label.

NOTE: Use of a torque wrench to tighten the bolts is required. A torque wrench will assure a proper torque has been applied to the HYMAX GRIP CUT-IN SLEEVE.

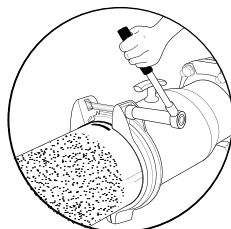

STEP 7

Recharge the line and check for leaks. If any leakage is evident, reduce the pressure in the line and increase bolt's torque by up to 50%. Verify again no leaks are evident along the seal.

<p>⚠ WARNING</p>  <p>NATURAL GAS</p> <p>NO!</p>	<p>Caution: This product is not intended for use on natural gas piping, or any other type of gas piping. To do so could result in escaping gas that could ignite and cause property damage, serious injury or death.</p>
---	---

HYMAX[®]

Repair the past. Connect the future.

 **KRAUSZ** is the creator of HYMAX

331SW 57TH AVENUE, OCALA, FLORIDA 34474

TEL: 855-457-2879 | 855-4KRAUSZ

FAX: 352-304-5787

info@krauszusa.com | www.krauszusa.com

This product is protected under a registered patent. See Krausz USA website for details. Copyright © 2018 Krausz Industries Ltd., All rights reserved

II0164 REV A